

Surface Mounted Series DIO 5190

DIODO

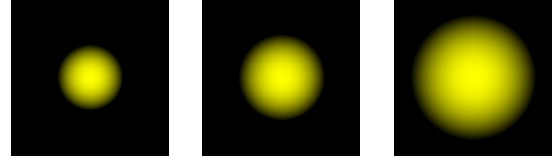
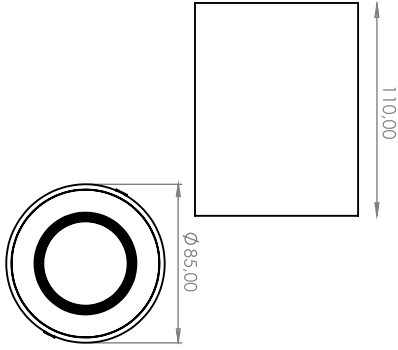
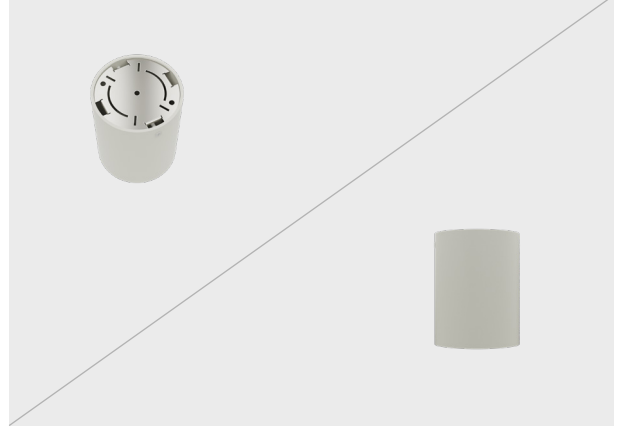

17°

36°

60°



20°

20°

www.diодо.com.tr

Materyal:	Alüminyum Gövde
Işık Kaynağı:	COB LED
Güç:	GU10 Led Bulb, 8W, 12W
Işık Renkleri:	2700K, 3000K, 3500K, 4000K, 5000K, 6500K
Renksel Geri Verim İndeksi (CRI):	80+, 90+
Reflektör Açısı:	17, 36, 60°
Çalışma Gerilimi:	220-240V / 50-60Hz
Gövde Boya Tipi:	Elektrostatik Toz Boya
IP Koruma Sınıfı:	IP20
Montaj Tipi:	Sıva Üzeri
Menşei:	Türkiye
Garanti:	5 Yıla kadar

Body Material:	Aluminum Body
Light Source:	COB LED
Power:	GU10 Led Bulb, 8W, 12W
Light Color (CCT):	2700K, 3000K, 3500K, 4000K, 5000K, 6500K
Color Rendering Index (CRI):	80+, 90+
Beam Angle:	17, 36, 60°
Mains Voltage:	220-240V / 50-60Hz
Painting Type:	Electrostatic Powder Coating
IP Protection Glass:	IP20
Installation:	Surface Mounted
Origin:	Turkey
Warranty:	Up to 5 years



CODE	WATT	DRIVER CURRENT	LUMEN
5191	-	-	-
5192	GU 10	-	375 lm
5193	8 Watt	200 mA	760 lm
5194	12 Watt	250 mA	1140 lm

AKSESUARLAR / ACCESSORIES

Petekli Filtre / Honeycomb Filter

